

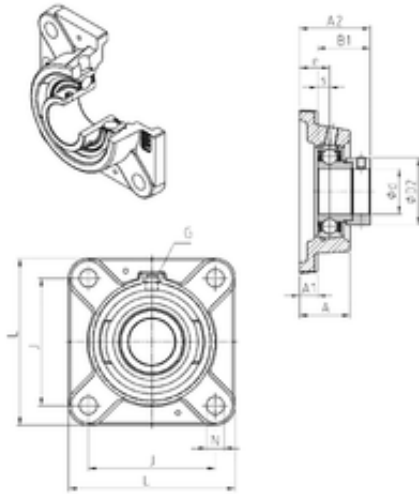

Duke Axis.

SNR ESFE203 Unidad De Rodamiento

Bearing No. ESFE203



ESFE203 Bearing 2D drawings and 3D CAD models

Bore Diameter	17 mm
d	17 mm
e	17 mm
s	6,5 mm
A	31 mm
A1	9,5 mm
B1	28,6 mm
D2	28,6 mm
J	54 mm
L	76 mm
N	11,5 mm
Thread (G)	M6x1
A2	39,1 mm
Weight	0,5 Kg
Basic dynamic load rating (C)	9,55 kN
B	19.1 mm
d1	27.2 mm
G	R1/8"
s1	23.05 mm
S	6.5 mm
C	9.55 kN
C0	4.78 kN
T min.	-20 ° C
T max.	100 ° C
Recommended tightening torque for set screw	5.5 Nm



Duke Axis.

Designation of housing	FE203-
Designation of bearing	ES203G2